



ESD122

1.2T Electric Waker Straddle Stacker

- Adjustable straddle-outrigger design
- Maintenance-free batteries with integrated charger
- Strong chassis and rigid mast
- Easy operation

iMOW
www.imowshop.com



Scan and Enter iMOW Website



iMOW

NO.121 Yonghua Street, Shiqiao Road, Xia Cheng Qu, Hangzhou, China 86-571-28035665

86-571-28035656/28878695

www.imowshop.com

info@imowshop.com

PRODUCT FEATURES

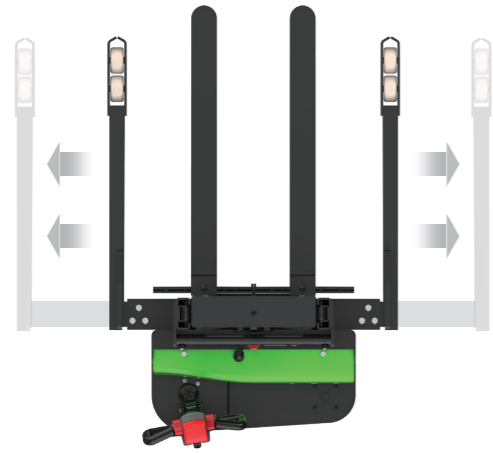

Adjustable straddle-outrigger design

ESD122 adopts adjustable straddle-outrigger design to stack various kinds of pallets, making it a perfect tool to cover multi handling tasks in warehouses. The forks of ESD122 is able to go very close to the ground and move right under the pallets without the bottom boards getting in the way. Operators are able to stack various sized pallets and reduce the leg span for efficient storage in a limited space.

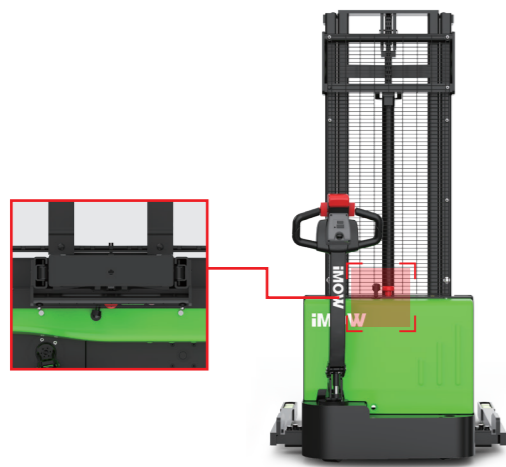

Maintenance-free batteries with integrated charger

ESD122 comes with two 12V/85Ah AGM batteries and an integrated charger as standard. It's maintenance-free and no special charging room required, which brings users more efficient and flexible operation.



Strong chassis and rigid mast

The side impact beam, plates and boxes make the chassis stronger and can greatly reduce stress and deformation caused by heavy load. The rigidity of the mast is greatly improved by its beam structure to provide smooth lifting and stacking for daily operation.

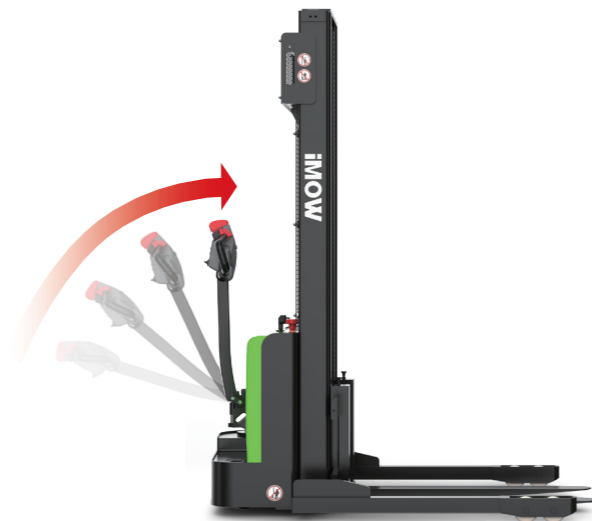

Easy operation

The extra-long and offset tiller with the crawl speed button provides ESD122 a better visibility and nimble maneuverability when operating in tight space.

PRODUCT PARAMETERS

Distinguishing mark	1.1			Manufacturer	iMOW
	1.2			Model designation	ESD122
Service weight	1.3			Drive	Electric
	1.4			Operator type	Standing
Tyres/chassis	1.5			Load capacity	Q kg 1200
	1.6			Load center distance	c mm 600
Dimensions	1.8			Load distance, centre of drive axle to fork	x mm 815
	1.9			Wheelbase	y mm 1245
Performance data	2.1			Service weight	kg 636
	2.2			Axle loading, laden front/rear	kg 683/1173
Electric-engine	2.3			Axle loading, unladen front/rear	kg 443/193
	3.1			Tyre type	Polyurethane
Addition data	3.2			Tyre size, front	φ210×70
	3.3			Tyre size, rear	φ100x50
Performance data	3.4			Additional wheels (caster wheels)	mm φ100x50
	3.5			Wheels, number front/rear (x=drive wheels)	mm 1x, 1/4
Performance data	3.6.1			Tread width, front	b ₁₀ mm 531
	3.7.1			Tread width, rear	b ₁₁ mm 1110/1210/1310
Performance data	4.0			Max. Lift Height	H mm 2490
	4.2			Retracted mast height	h ₁ mm 1856
Performance data	4.4			Lift height	h ₂ mm 2430
	4.5			Height, mast extended	h ₄ mm 3071
Performance data	4.9			Height of tiller handle in drive position min./max.	h ₁₄ mm 760/1140
	4.10			Height of wheel arms	h ₈ mm 100
Performance data	4.15			Lowered height	h ₁₃ mm 60
	4.19			Overall length	l ₁ mm 1653
Performance data	4.20			Length to face of forks	l ₂ mm 570
	4.21			Overall width	b ₁ /b ₂ mm 1185/1285/1385
Performance data	4.22			Fork dimensions	s×e×l mm 35×100×1070
	4.24			Fork carriage width	b ₃ mm 780
Performance data	4.25			Fork spread	b ₅ mm 200-760
	4.26			Distance between wheel arms/loading surfaces	b ₄ mm 1035/1135/1235
Performance data	4.31			Ground clearance, laden, below mast	m ₁ mm 80
	4.32			Ground clearance, center of wheelbase	m ₂ mm 20
Performance data	4.34.1			Aisle width for pallets 1000×1200 crossways	A _{st} mm 2305
	4.34.2			Aisle width for pallets 800×1200 lengthways	A _{st} mm 2233
Performance data	4.35			Turning radius	W _a mm 1477
	5.1			Travel speed, laden/unladen	km/h 4.2/4.5
Performance data	5.2			Lifting speed, laden/unladen	m/s 0.10/0.14
	5.3			Lowering speed, laden/unladen	m/s 0.10/0.10
Performance data	5.8			Max. gradeability, laden/unladen	% 3/10
	5.10			Service brake	Electromagnetic
Performance data	6.1			Drive motor rating S2 60 min	kW 0.75
	6.2			Lift motor rating at S3 15%	kW 2.2
Performance data	6.4			Battery voltage/nominal capacity	V/Ah 24/85
	6.5			Battery weight	kg 48
Performance data	8.1			Type of drive control	DC
	10.5			Steering design	Mechanical
Performance data	10.7			Sound pressure level at the driver's ear	dB(A) 74
	15.1			Charger output current	A 10

If there are improvements of technical parameters or configurations, no further notice will be given. The diagram shown may contain non-standard configurations.

LINE GRAPH

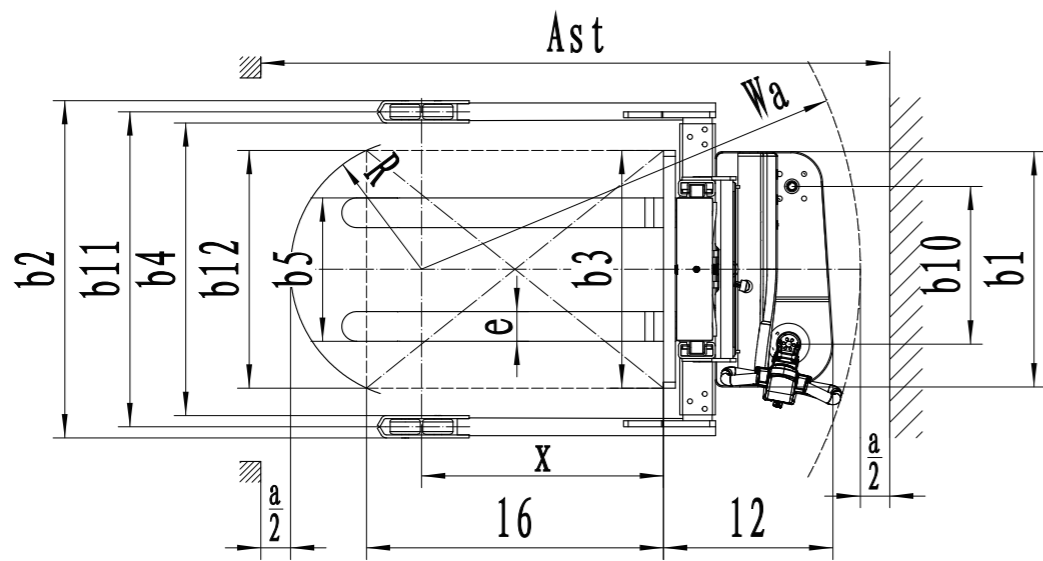
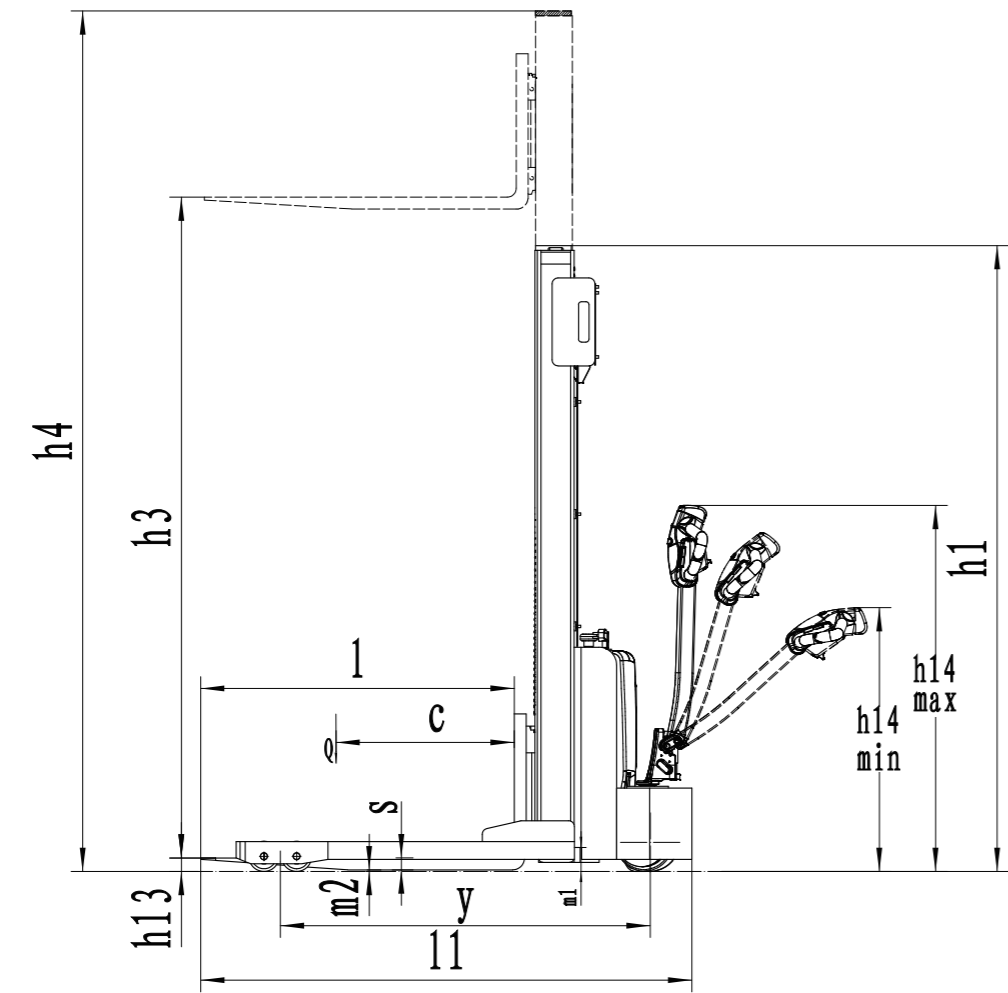

MAST OPTION

Mast types	Lift height h3+h13 (mm)	Height, mast lowered h1 (mm)	Free lift h2 (mm)	Height, mast extended h4 (mm)
2-Standard Mast	2490	1856	—	3071
	2690	1956	—	3271
	2990	2106	—	3571
	3290	2256	—	3871
	3590	2406	—	4171

OPTION

No.	Optional items	ESD122
1.1	Fork dimension	●1070○920○1150○1220
1.3	Fork lowered height	●60
2.1	Load wheel type	●Double
2.2	Load wheel material	●PU
2.3	Drive wheel material	●PU
2.7	Battery capacity	●85Ah
2.8	Charger	●24V-10A Internal
3.2	Fork carriage	●No○800
3.3	Castor wheels	●Yes and not customized
3.16	Vertical handler working	●Yes and not customized

Note: ●Standard ○Optional - Inconformity

RATED CAPACITY

RATED CAPACITIES GRAPH

